



Studioscape

flexible working spaces



modular flexible upholstery



About

Studioscape is a modular system of seating and tables, planters and power/data units.

By bringing people and plants together in the same system Studioscape gives you a great tool to create healthy, effective spaces.

There are two seating heights and four table heights.

All are cross-compatible due to the 750x750 grid. This makes for a huge range of space-planning options and really easy reconfiguration.

grid system

Modularity | flexible for now and the future

All of the standard furniture modules fit into a 750x750 grid.

This is important as it means all the elements are cross-compatible, now and into the future.

As needs change, so can your layout without compromise. You can add elements at a later date, or remove and relocate elements.

Of course modularity is also great for access and delivery, and in the future if you need to repair an element it is easier to remove one item than a whole installation.

The planter system also uses modularity. There are 2 plants per 750 grid square and these are planted in individual liners which can be easily exchanged or replaced as the plants grow.

The 750 grid relates well to human scale – it is a comfortable social spacing, yet smaller than some modular systems meaning you can fit more in.

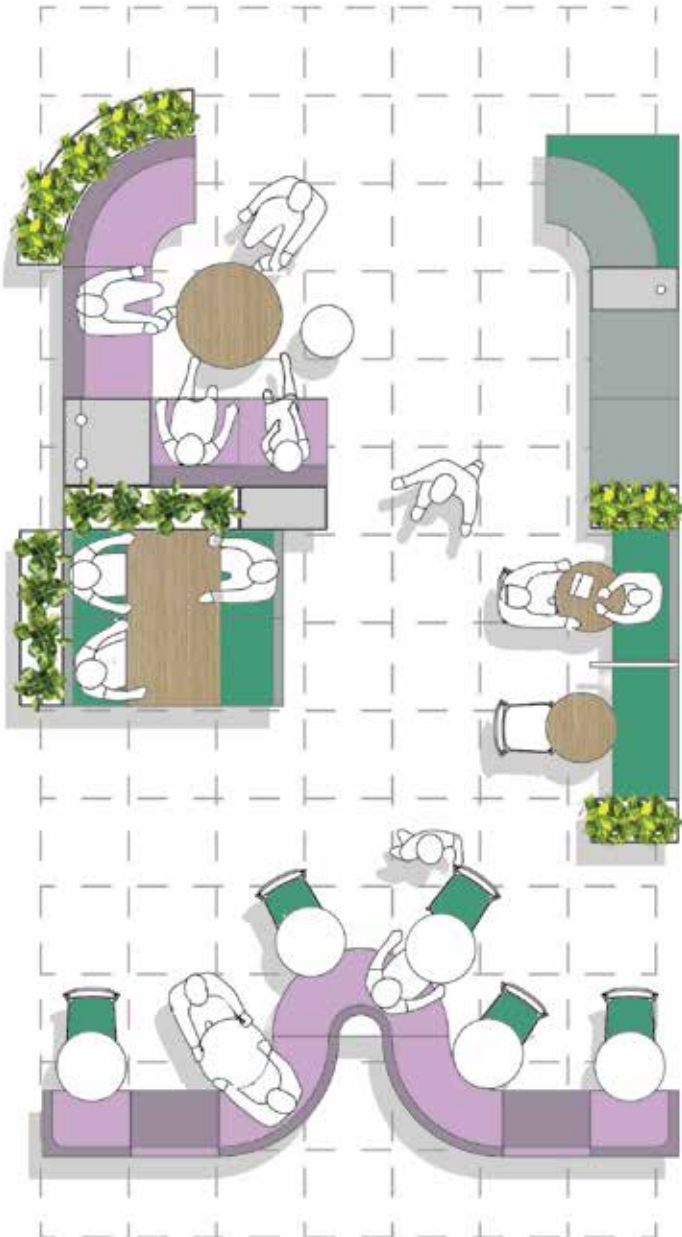

modules



Sofa module

With a 380mm seat height - the seat has a webbed suspension which means it is firm but resilient.

Perfect for informal meetings, and ideal too for touchdown working combined with a 600mm high table.



Dining / Meeting module

The dining and meeting module has a higher seat and a higher back for support. Seat height 450mm.

The seat is also firmer and shallower than the sofa module. It is ideal as a more flexible alternative to banquettes and booths.



Screens

Screened seating elements in straights and curves allow visual and acoustic separation.

They allow the system to be used to make up booths, or effectively and subtly divide up a space.



Planters

As mobile and flexible as the seating - planters can demarcate settings and integrate plants with people.

Our tried and tested system separates the upholstered elements with a waterproof surface at the point of contact when watering.

in-line tables



We offer in-line tables in three heights, all can house power and recharge units.

LOW: maintains the most open and flowing lounge seating arrangements.



MEDIUM: height aligns with the seat and is a great side table for working – place your papers here which you recharge your phone and catch up on some work.



HIGH table or armrest: creates more separation for greater seating density.

base options



01 - SLED BASE

Powder coated: grey, white or black



02 - CASTORS

with 2 out of 4 per unit being locking

additions



Power

Power units can be fitted to seating, screens and table elements, but not planters.

We work closely with UK manufacturer OE electrics on our power solutions. We recommend:

- Pixel units and Arc80 wireless chargers for tables (surface mounted)
- Phase units for seating (under-mounted)
- Puma for screens.



Meeting tables

Tables from our Laser and Disc ranges partner well with Studioscape.

Disc with it's flat base (squares and ovals as well as discs) are best when the table is relatively fixed.

Laser (with a cruciform base) is better for pulling up close to you when seated, particularly the triangular laptop table.

Drum stools

Mobile stools enable a greater number of flexible arrangements to be interpreted.

At 450mm high, these suite with either dining height or lounge settings.



Coffee tables

For more informal settings the Mycroft table provides side and coffee table options.

In solid Oak – either natural oiled or stained black, it is a great tool to soften a setting.

Planter system

Our motivation to bring living plants into the workplace is to enable people to experience the healthier environment they create.

We provide plants through our plant specialist already potted in a plastic liner which incorporates its own watering system. The liners are modular, so it is as easy to mix and match the plants as it is the furniture.

To further protect the upholstery, we use waterproof ply to construct the planters, and each planter has a top made of compact grade laminate in six standard finishes (black, light and dark grey, white, Oak and Walnut). So no need to worry about any drips from watering.

The watering system means the liners need topping up only every 3 or 4 weeks in summer.

Our partners can provide maintenance services for your plants. Or, if you already have a plant supplier and would like to supply your own plants, we are happy to provide the specification for the liner.

We can also supply artificial plants, but not without trying to persuade you to go for real plants first!

SMALL PLANT
Mix of Philodendron and
Ophiopogon



• –
220
• –

MEDIUM PLANT
Rhaps Palm



• –
400
• –

TALL PLANT
Dracaena Marginata



• –
900
• –

sofa modules

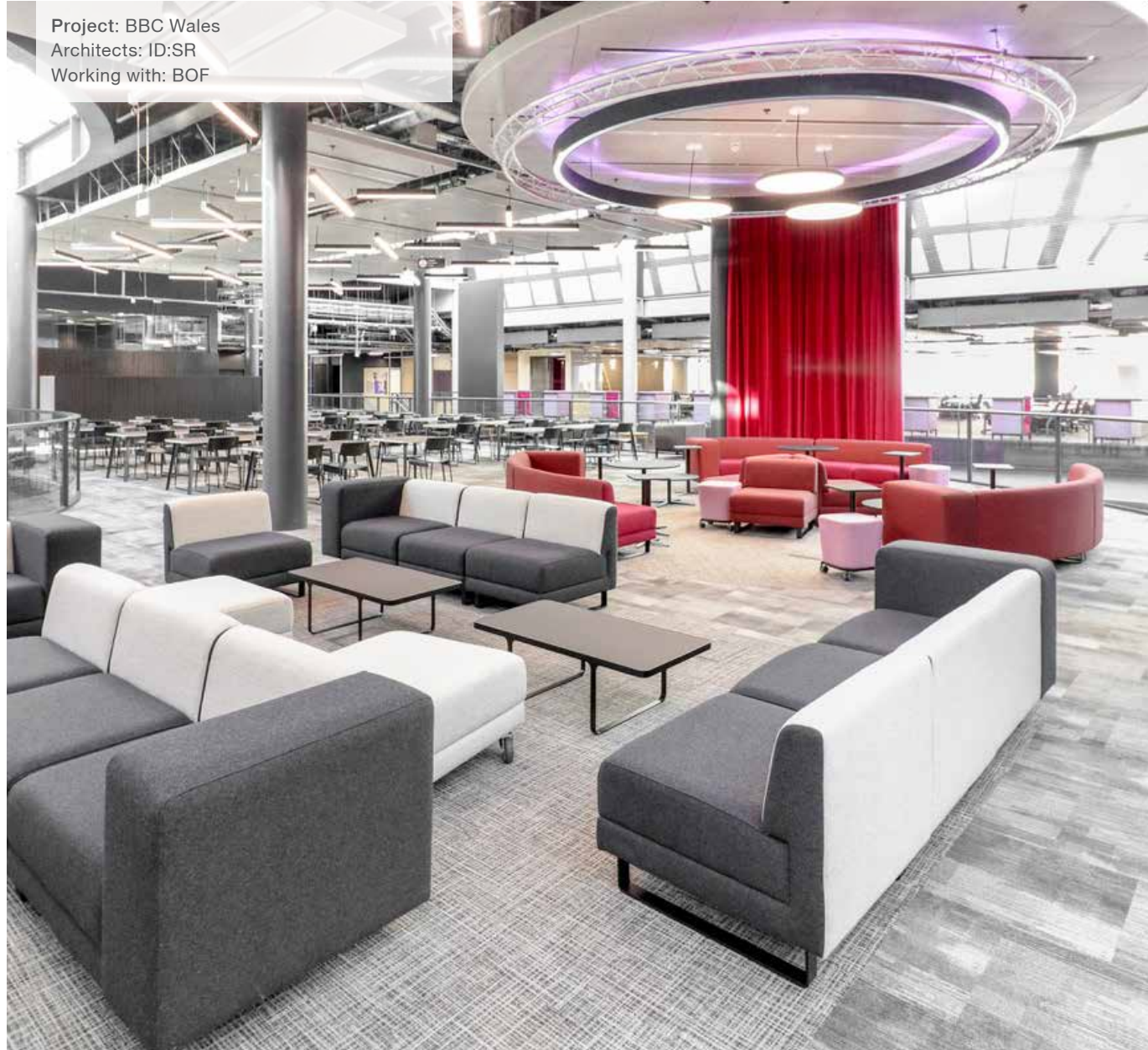

sofa modules

Project: British Veterinary Association
Architects: Manalo & White
Working with: The Furniture Practice

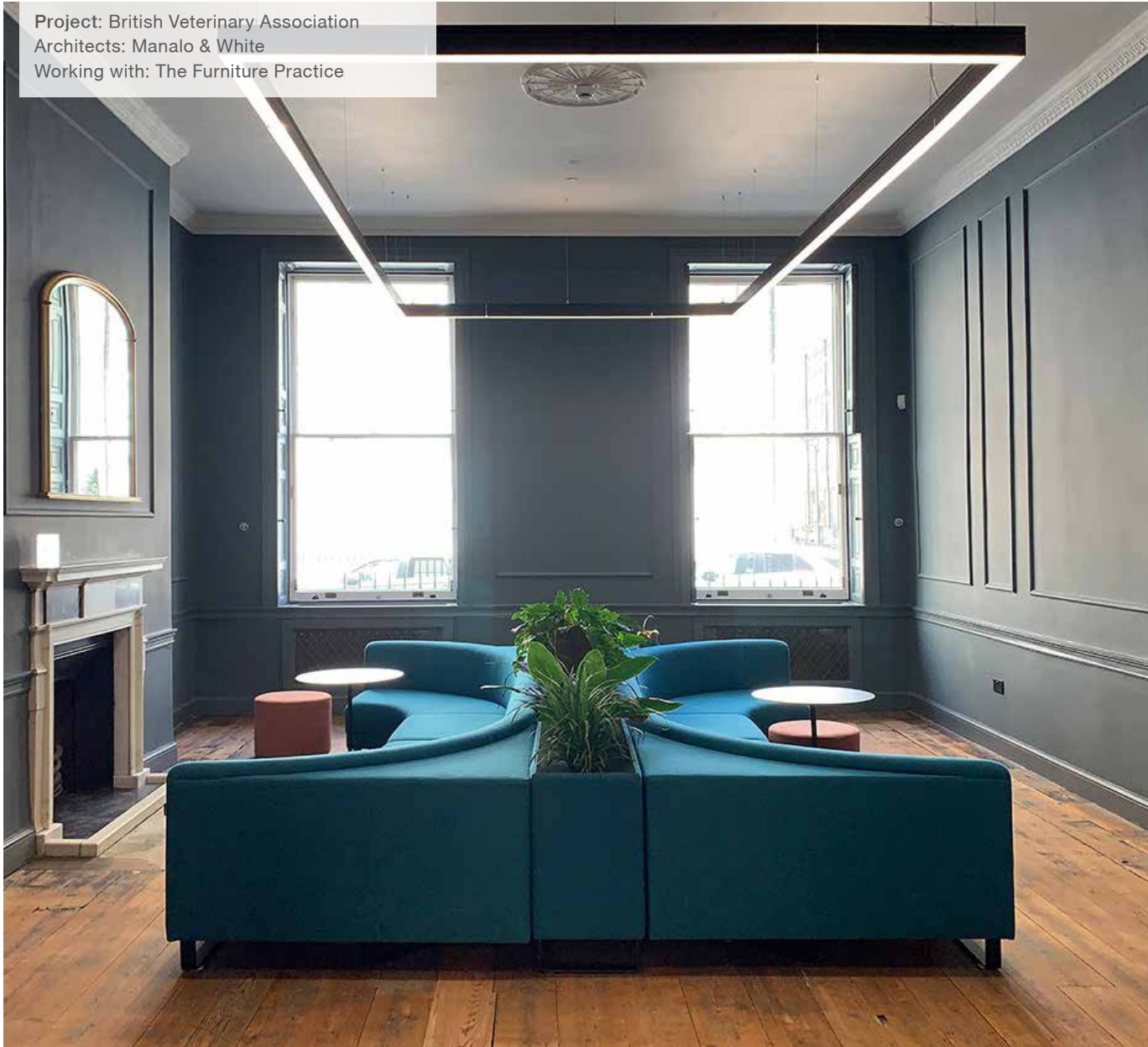

dining modules



Dining configuration example #1



Dining configuration example #2



Dining configuration example #3



Dining and Lounge configuration example #4

dimensions (width x depth x height; seat height)

Sofa modules | seat height : 380



single sofa
w750 x d750 x h720; sh 380

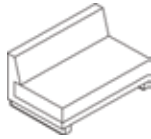

small sofa
w1125 x d750 x h720; sh 380

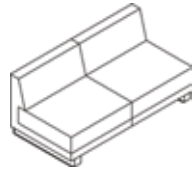

double sofa
w1500 x d750 x h720; sh 380



curve back corner sofa
w1125 x d1125 x h720; sh 380

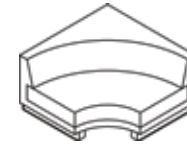

square back corner sofa
w1125 x d1125 x h720; sh 380

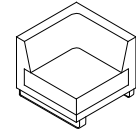

end sofa
w750 x d750 x h720; sh 380



60 degree curve sofa
w975 x d940 x h720; sh 380



60 degree corner sofa
w975 x d940 x h720; sh 380

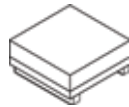

single bench
w750 x d750 x h380; sh 380

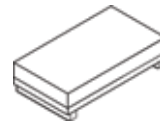

small bench
w1125 x d750 x h380; sh 380

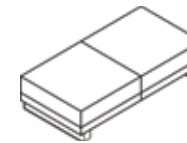

double bench
w1500 x d750 x h380; sh 380

Dining modules | seat height : 450



single dining module
w750 x d562 x h900; sh 450



small dining module
w1125 x d562 x h900; sh 450



double dining module
w1500 x d562 x h900; sh 450



end dining module
w750 x d562 x h900; sh 450



square back dining module
w750 x d562 x h900; sh 450



curve back dining module
w750 x d562 x h900; sh 450



60 degree curved corner module
w750 x d562 x h900; sh 450



60 degree square corner module
w750 x d562 x h900; sh 450

dimensions (width x depth x height; seat height)

Coffee tables & arm rest



low coffee table
w750 x d750 x h200



medium coffee table
w750 x d750 x h380



high table arm rest
w375 x d750 x h690

Planters



single planter
w375 x d750 x h690

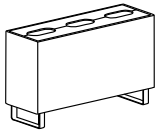

small planter
w1125 x d375 x h690

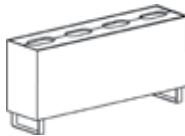

double planter
w1500 x d375 x h380



curved planter
w1500 x d1500 x h690

Screens



single screen
w1500 x d65 x h1250



small screen
w1125 x d65 x h1250

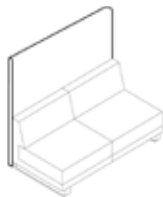

double screen
w1500 x d65 x h1250

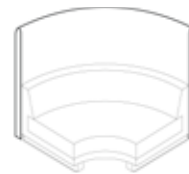

curved screen
1125 radius x d65 x h1250

materials



Materials

Frame:

FSC Timber and Birch plywood frame glued and screwed

Upholstery:

CMHR foam over webbing

Base:

Steel

Surfaces:

Compact laminate

Production

100% made in the UK

sustainability



Sustainable in the true sense of the word, MARK's furniture is designed to last. This applies right through from creative decisions about form, to choice of materials and methods of production.

Using prudent, considered design to be resourceful – making our furniture the best we can with the minimum physical resource.

These principles have a positive and measurable impact on our 'triple bottom line' of people, planet and profit.

Design for durability:

Studioscape can be re-upholstered for the simple fact that, by changing this most immediate of touch points, the lifespan of the product can extend beyond the life of a colour scheme.

Local manufacture:

We manufacture in the UK. Local is important to us and as such we are bringing value into the UK's poorest region (Cornwall), to reduce manufacturing miles and sustaining our community.

Responsible sourcing:

All timber within Studioscape is FSC certified. Using and extending our knowledge to ensure we're not using materials and processes that are harmful to the environment.

Lifecycle:

Our products carry a 10 year warranty and Studioscape is a 100% recyclable.

The modular formation ensures it can be reconfigured with any changing office landscape.

project snapshots



BBC Wales | ID:SR



Plymouth University



RCA | IDEA



Falmouth University | Hart Miller Design



Financial Services | 202



Segro | Manalo & White



Corpus Christi



Modus | Fujitsu



Financial Services | 190



BBC Wales | ID:SR



We're here to help.

Showroom and Sales:

1 St John's Square,
Clerkenwell,
London,
EC1M 4DH

020 7490 7718

Head office and Production:

Rosemanowes Quarry,
Herniss,
Penryn,
Cornwall,
TR10 9DU

01209 860 133

enquiries@markproduct.com